

# STAFF OFFICES AND RESOURCE AREA

## Additional Staff Space and Resource Center

### Staff Needs

Many shelters were never built to serve as housing or workplaces. As such, shelter employees are accustomed to sharing desks and working in tight, makeshift spaces that are scattered throughout the facility and not conducive to positive client interactions.

In order to accommodate our staffing needs and provide program office space more accessible to clients, new offices will be included in the renovations in the Administrative area. This will improve collaboration, workspace and client care.

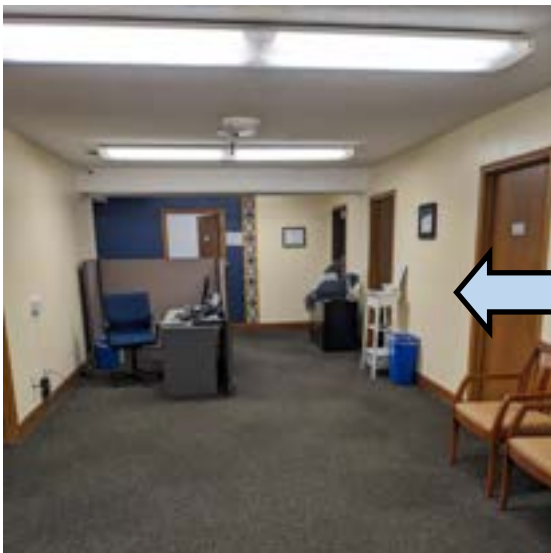

### Sponsorship Opportunity

Life Coach Offices (4)

\$2,500 each

Furniture, Décor,  
Overhead



Offices will be remodeled to incorporate a calming, open and inviting design. A small meeting room will be established for client counseling and visitor meetings along with a new centralized resource area for staff.

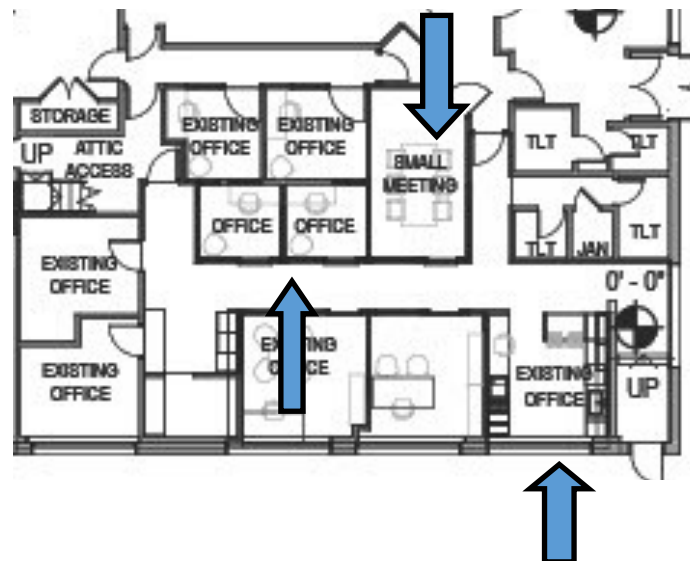

## **Sponsorship Opportunity**

### **Staff Resource Area:**

We are looking for a group to adopt this area and equip the lounge with basic office supplies, new mailboxes, and resource needs.

Estimated Cost:

Gift In Kind provided by sponsor



## **Resource Center**

Caring for people who are experiencing homelessness can be both emotionally and physically draining. When possible, staff should have a place to themselves where they can unwind, eat, and socialize. Such a space can provide relief from the active client centered environment of the rest of the shelter and prevent compassion fatigue and burnout.

Shelter KC has never had a space dedicated to employees outside of the Administration area. Renovation plans include transitioning the front office into a staff resource area.



## **Sponsorship Opportunity**

### **Staff Kitchen:**

A small kitchenette will be built into the Staff Resource Area. A group or individual may sponsor this area and provide a new coffee station, and basic kitchen equipment.

Estimated Cost:

Gift In Kind provided by sponsor

